



**L&T Electrical & Automation**

# **CZ** SWITCH DISCONNECTORS



**Superior Performance  
in tough conditions**

*Switchgear Factory, Ahmednagar*



*Switchgear Factory, Navi Mumbai*



L&T Electrical & Automation (E&A) is a market leader for electrical distribution, monitoring and control solutions in the low voltage category.

Popular among customers as L&T Switchgear, E&A offers a wide range of low and medium voltage switchgear, motor starters, electrical systems, industrial automation building electrical solutions, energy management solutions, electrical modernization solutions and metering solutions. Its products and solutions cater to key sectors of economy like industries, utilities, infrastructure, building and agriculture.

E&A's manufacturing operations at Navi Mumbai, Ahmednagar, Vadodara, Coimbatore and Mysuru in India adhere to global practices of excellence and receive support from well-equipped in-house design and development centres as well as tooling facilities that contribute to precision in manufacturing.



*Switchgear Factory, Vadodara*

## Contents

Standards & Approvals 05

Product Range 06

Universal Mounting 06

Detailed View 07

Technical Specifications 09

Ordering Information 11

Overall Dimensions & Accessories Fitments (CZ1) 12

Overall Dimensions & Accessories Fitments (CZ2) 16

# CZ Switch Disconnectors

E&A now offers wide range of Switch-Disconnectors suitable for multitude of applications like power distribution, isolation in solar power plants, local ON/OFF control for machines & motor, to name a few.

Available in both open and ready to use SS enclosure versions, the CZ Switch Disconnectors are easy to install, operate and inspect. Armored with safety features like terminal shrouds, phase barriers & door interlock, the CZ Switch Disconnectors are designed to battle against accidental faults and inadvertent operations. Robust construction allows to withstand higher fault currents without any deterioration.

## Designed For Indian Ambient Conditions

CZ Switch Disconnectors are rugged and suitable to carry rated current at high temperatures experienced in Indian Sub-Continent. Also, the terminals are designed to accommodate Aluminum cables/bus bars.

## Safety Guaranteed

There is no benefit of the doubt allowed when it comes to safety. Terminal shrouds protect against accidental human contact with the live terminals, phase barriers stand in line of any phase to phase flashovers and high ground clearance eliminates any possibility of grounding live cables/links.

## Different Operational Voltages For Different Needs

CZ family of Switch Disconnectors have dedicated range for different voltages (upto 800V AC, 1000V DC, 1500V DC). While power distribution normally requires 415V ac rated SDs, other applications like metal furnaces require 690V ac SDs. Also, 800 Vac and 1500 Vdc SDs are common requirement in Solar applications.







### **Diverse Needs, Varied Options**

Both direct and extended handle versions are available to meet diverse application needs. The extended or panel mounted handle is IP54 rated for extreme external environment. Also, the length of the extended shaft can be adjusted to align with different panel sizes.

### **Contact System & Mechanism**

CZ SDs have modular construction with separate cassettes for mechanism and contact system. Contact system cassette (pole assembly) consists of rotor assembly housing moving contacts, terminals and arc-chutes. The contact system is double break knife type. Mechanism is quick make-quick break and multi-cams type for smooth and efficient torque transmission. Moreover, the contacts are visible through transparent window section to know actual status of contact system

### **For A Sustainable Future**

All the materials used for components, welding and plating on metallic components are RoHS compliant. Material used for packaging is recyclable.

### **Accessories**

#### **a) Auxiliary Contacts**

Upto 2nos. 1NO + 1NC can be fitted for ON/OFF status indication. The auxiliary contacts module is front mounted, plug-in type and can be fitted at the site. Auxiliary contacts actuation is from the main mechanism shaft. Addition of these contacts does not alter over-all dimensions of the switch.

#### **b) Castell Key Lock**

The CZ SDs can be interlocked with the help of Castell locks.

### Switch-Disconnecter range comply with following standards

- **IEC 60947-1, EN 60947-1, IS/IEC 60947-1**  
Low-voltage switchgear and controlgear, Part 1: General Rules
- **IEC 60947-3, EN 60947-3, IS/IEC 60947-3**  
Low-voltage switchgear and controlgear, Part 3: Switches, disconnectors, switch-disconnectors and fuse combination units



### NABL

NABL accreditation is a formal recognition of the technical competence of testing, calibration or medical laboratory for a specific task following ISO/IEC 17025:2005 Standard.

Accredited laboratories have the responsibility of satisfying the criteria of laboratory accreditation at all times, which are verified during Surveillance and Reassessment visits by NABL.

Further the accredited laboratories should prove their technical competence by satisfactory participation in recognized Proficiency Testing Programmes. L&T's Switchgear Testing Lab is NABL accredited subject to continued satisfactory compliance to above standard & additional requirements of NABL. Switch Disconnector range is tested in L&T's NABL accredited Switchgear Testing Lab.



### CE Marking







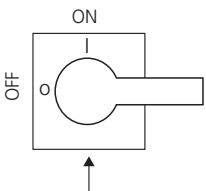
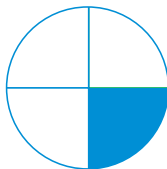
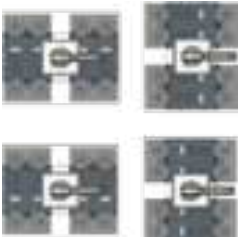
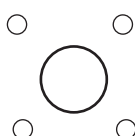

A CE marking is a European marking of conformity that indicates a product complies with the essential requirements of the applicable European laws or directives with respect to safety, health and environment and consumer protection. Generally, this conformity to the applicable directives is done through self-declaration and is required on products in the countries of the European Economic Area (EEA) to facilitate trade among the member countries. The manufacturer or their authorized representative established in the EEA is responsible for affixing the CE marking to their product. The CE marking provides a means for a manufacturer to demonstrate that a product complies with a common set of laws required by all countries in the EEA to allow free movement of trade within the EEA countries.

L&T's Switch-Disconnectorrang Confirm to the low Voltage directive 73/23/EEC as amended by directive 93/68/EEC, provided it is used in the application for which it is made and is installed and maintained in accordance with professional practices with relevant installation standards and operating instructions.

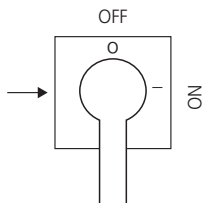
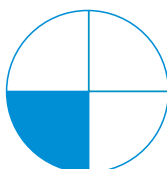
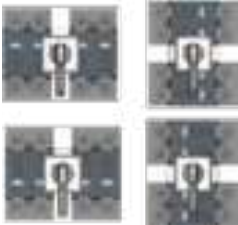
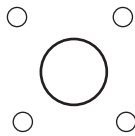
## Product Range

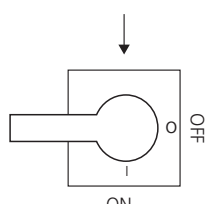
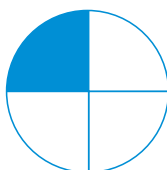
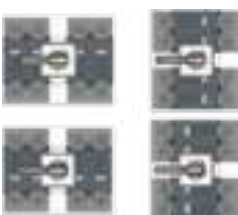
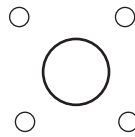
Product Range and Versions	Voltage	No. of poles	Handle Type	Mechanism/ Handle Position
<b>CZ Switch Disconnecter</b>	800 Vac	2P	Extended	Front Operated, Side
	800 Vac	3P	Direct	Front Operated, Side
	800 Vac	3P	Extended	Front Operated, Side
	800 Vac	4P	Direct	Front Operated, Center
	800 Vac	4P	Extended	Front Operated, Center

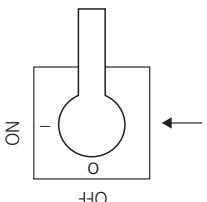
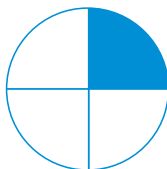
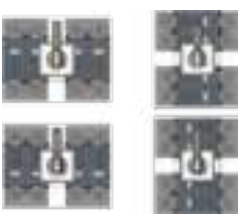
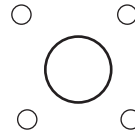
## Universal Mounting

Sr. No.	Handle (OFF) Position	Operating Quadrant (hand)	Switch Orientation	Door Cut-out	Shaft Position
1					
2					
3					
4					

## Detailed View

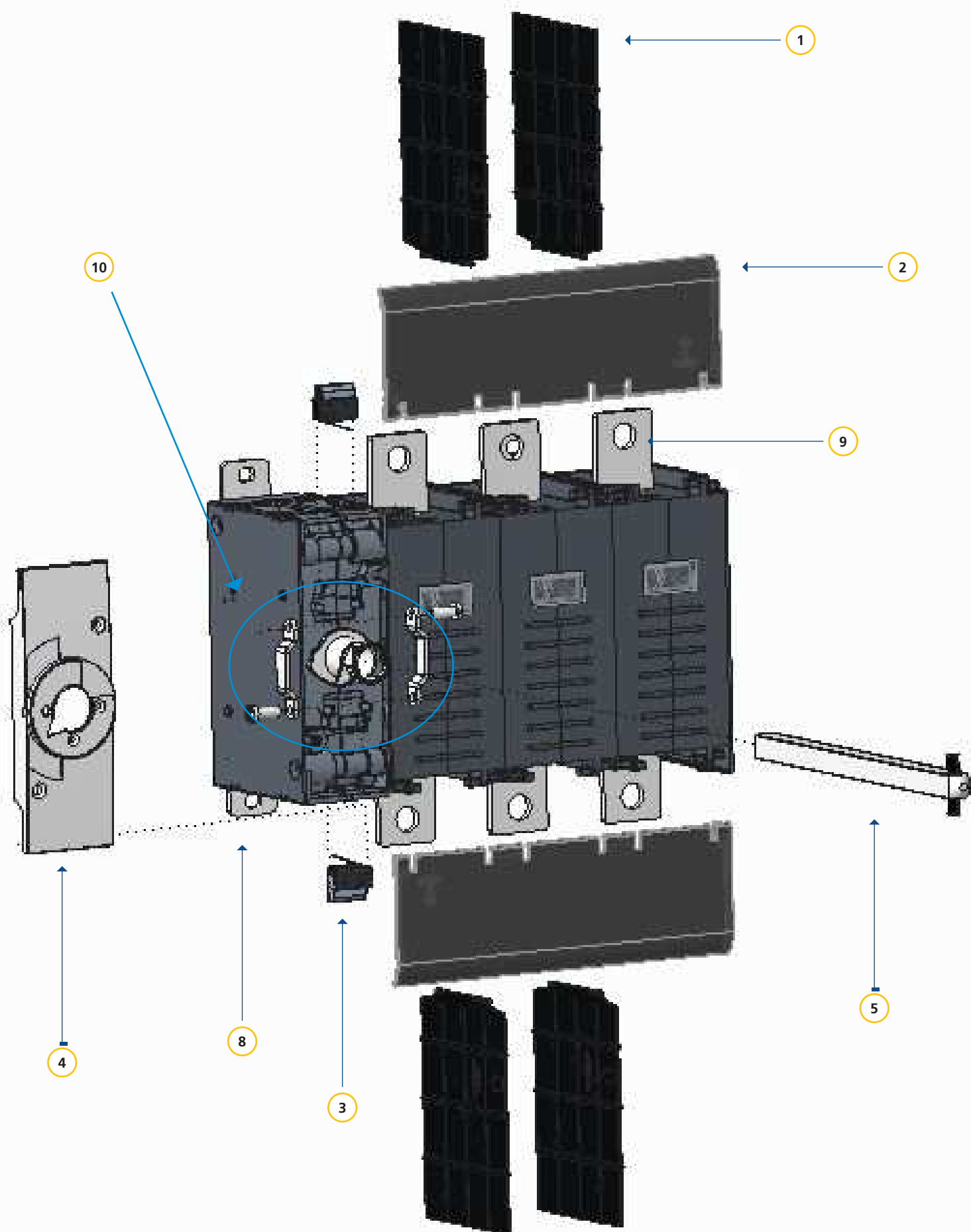



11

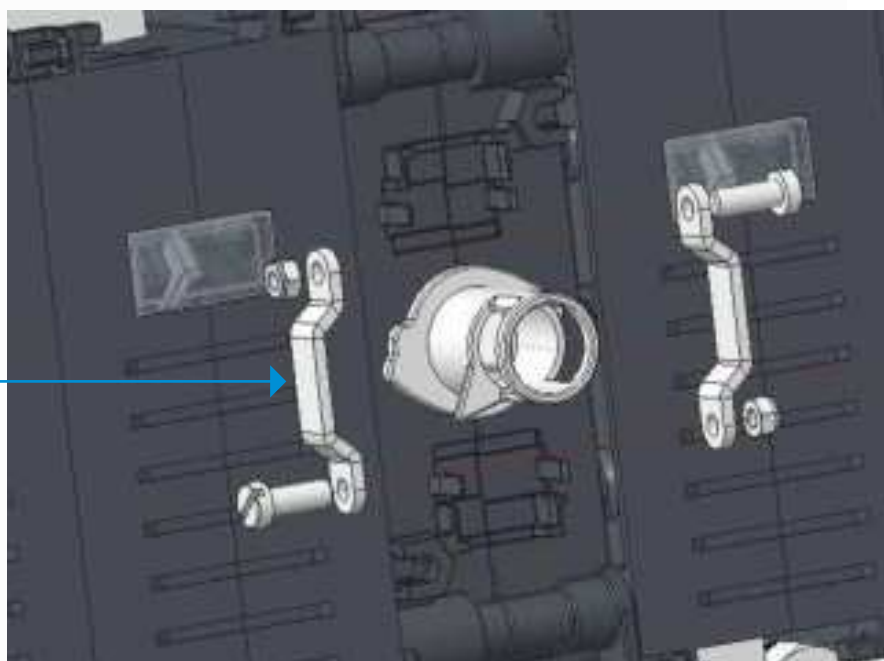

6

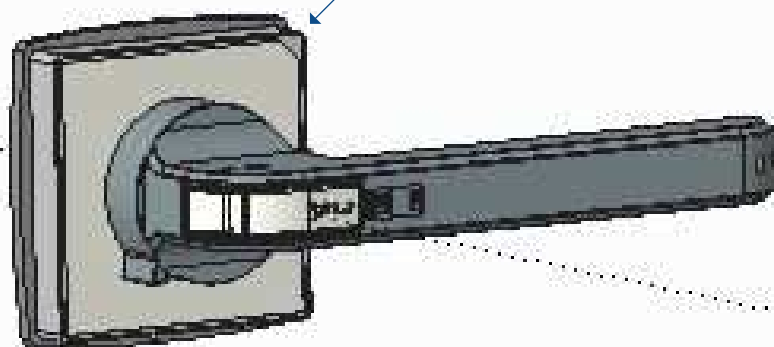

7

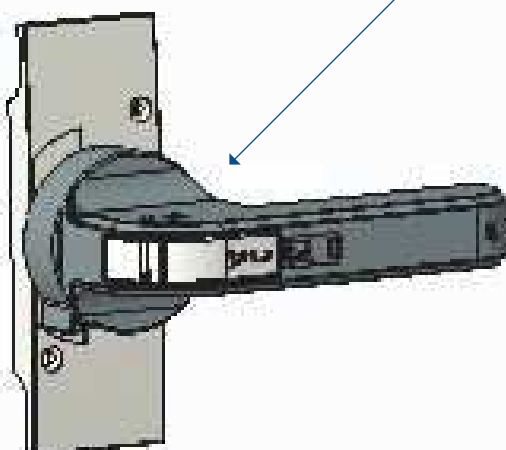

1. Phase Barrier (Standard accessory)
2. Terminal shroud (Standard accessory)
3. Auxiliary Contact (Optional accessory)
4. Front cover
5. Extended shaft
6. Extended Handle
7. Direct Handle
8. Mounting bracket
9. Terminals
10. Shaft locking arrangement
11. Detailed view of shaft locking arrangement

## Technical Specification for AC Switch Disconnectors

			125A	160A
Model			CZ-1	CZ-1
Compliance to Standards				
No. of Poles			2,3,4	2,3,4
Conventional enclosed thermal current (I <sub>the</sub> )	40°C	A	125	160
	50°C	A	125	160
Pollution Degree			3	3
Rated Operational Voltage (U <sub>e</sub> , Max)			V	800
Rated Impulse withstand voltage (U <sub>imp</sub> )			kV	12
Rated Insulation voltage (U <sub>i</sub> )			V	1250
Rated Frequency			Hz	
Rated Operational Current (I <sub>e</sub> )	AC-23A at 690Vac	A	125	160
Rated Operational Current/Poles in Series; DC 21B	220Vdc	A	125/1	160/1
	440Vdc	A	125/2	160/2
Rated Short Time Withstand Current (I <sub>cw</sub> , rms)	1 Sec	kA	8	8
	0.15 sec	kA	15	15
	0.25 Sec	kA	15	15
Rated Short Circuit Making Capacity (I <sub>cm</sub> , Peak)			kA	30
Rated Conditional Short-Circuit Current (I <sub>q</sub> , Peak)			kA	100
Rated Breaking Capacity	AC-23A at 690 Vac	kA	1.0	1.3
Rated Operational Power, AC-23A	At 415V	kW	75	90
	At 690V	kW	110	160
Power Loss/Pole			W	1.8
Operational Performance capability	Electrical	Nos.	2000	2000
	Mechanical	Nos.	20000	20000
Operating Torque			N-m	9
Maximum Termination Capacity	Lug Size	mm <sup>2</sup>	2 X 185	2 X 185
	Link Size	mm <sup>2</sup>	2 X 35 X 10	2 X 35 X 10
Terminal Bolt size			M10	M10
Terminal Tightening Torque			N-m	20
Weight	4P	kg	2.4	2.4

200A	250A	315A	315A	400A	630A
CZ-1	CZ-1	CZ-1	CZ-2	CZ-2	CZ-2
IEC 60947-3, IS/IEC 60947-3, EN 60947-3					
2,3,4	2,3,4	2,3,4	2,3,4	2,3,4	2,3,4
200	250	315	315	400	630
200	250	315	315	400	630
3	3	3	3	3	3
800	800	800	800	800	800
12	12	12	12	12	12
1250	1250	1250	1250	1250	1250
50/60					
200	250	315	315	400	630
200/1	250/1	315/1	315/1	400/1	630/1
200/2	250/2	315/2	315/2	315/2	630/2
8	8	10	16	16	20
15	15	15	31	31	38
15	15	15	24	24	36
30	30	30	45	45	45
100	100	100	100	100	100
1.6	2.0	2.5	2.5	3.2	5.0
110	132	160	160	200	355
180	200	250	250	355	600
4.6	7.1	11.3	7.5	12.2	23.8
2000	2000	2000	2000	2000	2000
20000	20000	20000	20000	20000	20000
9	9	9	18	18	20
2 X 185	2 X 185	2 X 240	2 X 300	2 X 300	2 X 300
2 X 35 X 10	2 X 35 X 10	2 X 35 X 10	2 X 50 X12	2 X 50 X12	2 X 50 X12
M10	M10	M12	M12	M12	M12
20	20	20	27	27	27
2.4	2.4	2.4	4.6	4.6	5.1

## Ordering Information

Version	Frame Size	Current Rating(A)	Voltage	No. of poles	Handle type	Mechanism Position	CAT no.
CZ SD-Open Execution SD	1	125A	800Vac	4P	P	Front, Center	CK90769 0000
	1	160A	800Vac	4P	P	Front, Center	CK90770 0000
	1	200A	800Vac	4P	P	Front, Center	CK90771 0000
	1	250A	800Vac	4P	P	Front, Center	CK90772 0000
	1	315A	800Vac	4P	P	Front, Center	CK90773 0000
	2	315A	800Vac	4P	P	Front, Center	CK90857 0000
	2	400A	800Vac	4P	P	Front, Center	CK90858 0000
	2	630A	800Vac	4P	P	Front, Center	CK90859 0000
CZ SD-SS enclosure	1	125A	800Vac	4P	P	Front, Center	CK908190000
	1	160A	800Vac	4P	P	Front, Center	CK908200000
	1	200A	800Vac	4P	P	Front, Center	CK908210000
	1	250A	800Vac	4P	P	Front, Center	CK908220000
	1	315A	800Vac	4P	P	Front, Center	CK908230000
	2	315A	800Vac	4P	P	Front, Center	CK908780000
	2	400A	800Vac	4P	P	Front, Center	CK908790000
	2	630A	800Vac	4P	P	Front, Center	CK908800000
CZ	1 & 2	125A to 630A	800Vac	2P	P	Front, Side	*
			800Vac	3P	P	Front, Side	
			800Vac	3P	D	Front, Side	
			800Vac	4P	D	Front, Side	
CZ Auxiliary Contact Kit (1 C/O contact)	1 & 2	125A to 630A	-	-	-	-	CK908050000

P-Extended handle suitable for panel door mounting  
D-Direct handle suitable for direct mounting on the product

Notes:  
\* Please contact our nearest branch office for further details  
Separate offerings for Solar applications (800Vac and 1000Vdc/1500Vdc) are also available.

## Overall Dimensions

## CZ1 AC SD 125/160/200/250/315A

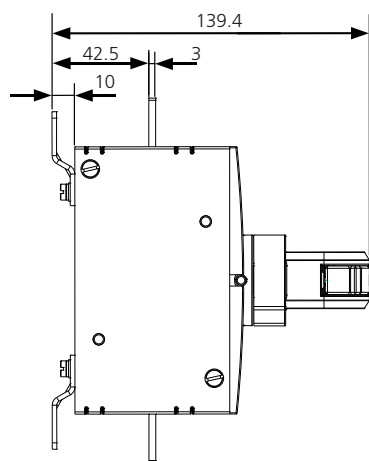
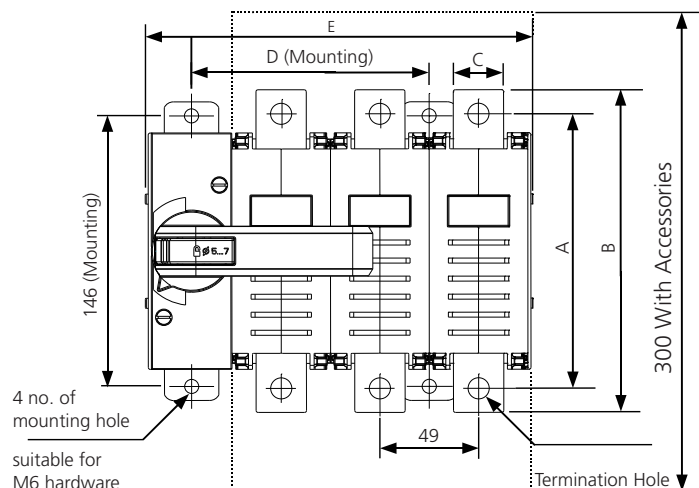

Direct Handle Version

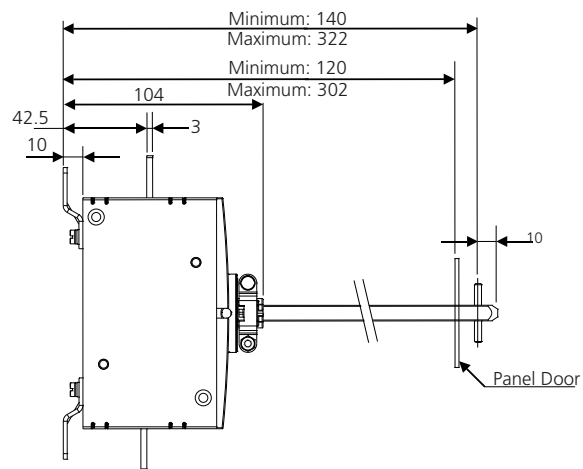

Panel Handle Version

Rating(A)	No. of poles	A	B	C	D	E	Hardware suitable for termination
125-250	2P	137	161	25	69	144	M10
	3P	137	161	25	118	193	
	4P	137	161	25	138	242	
315	2P	150	180	35	69	144	M12
	3P	150	180	35	118	193	
	4P	150	180	35	138	242	



## Panel Cutout

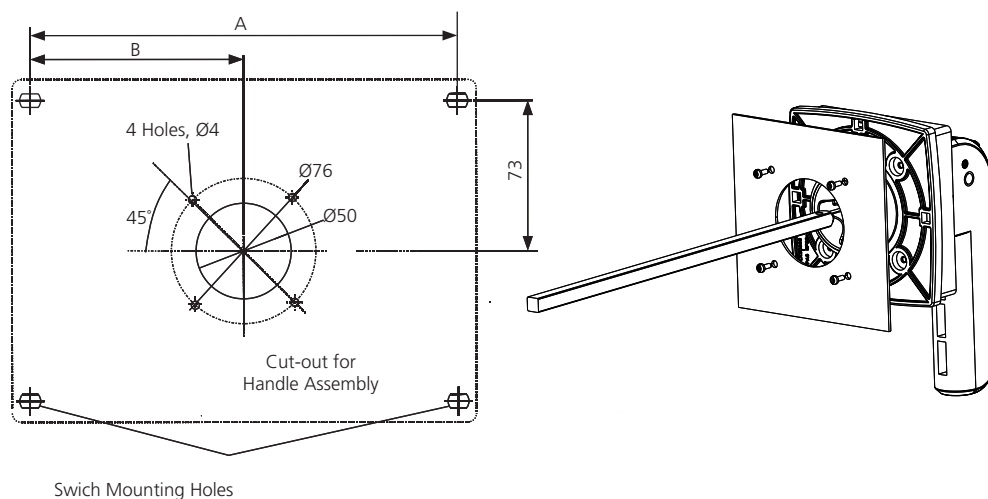

No. of Poles	A	B
2P	69	0
3P	118	0
4P	138	69

## Mounting Orientation

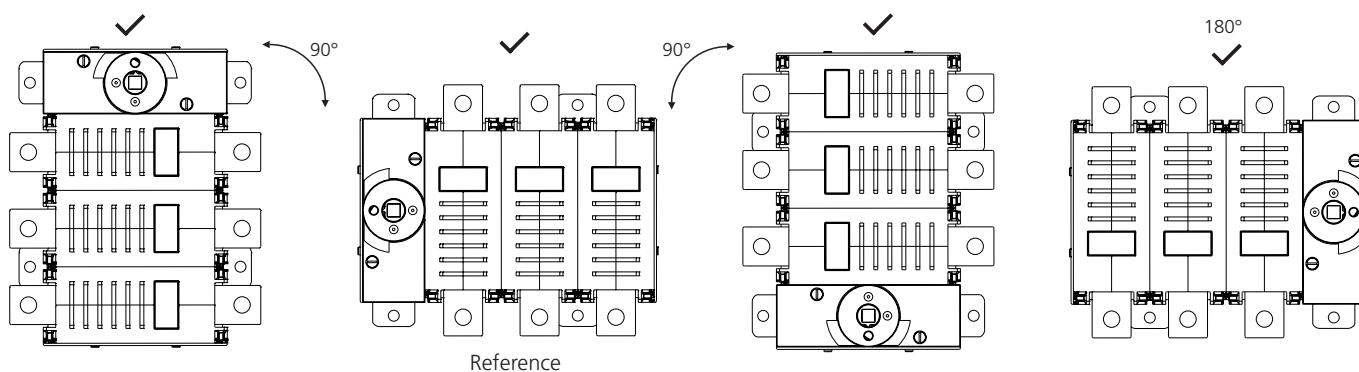

## Enclosure size and enclosure mounting

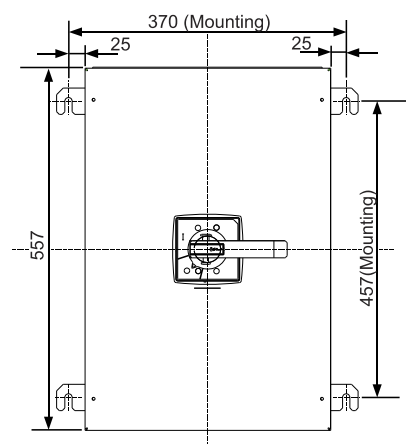
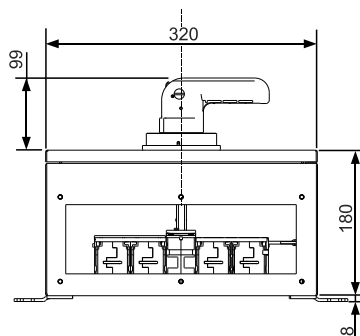

### Phase Barrier Fitment

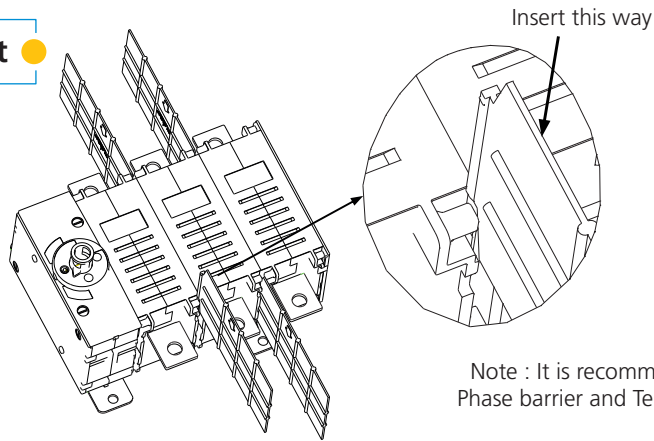

### Terminal Shroud Fitment

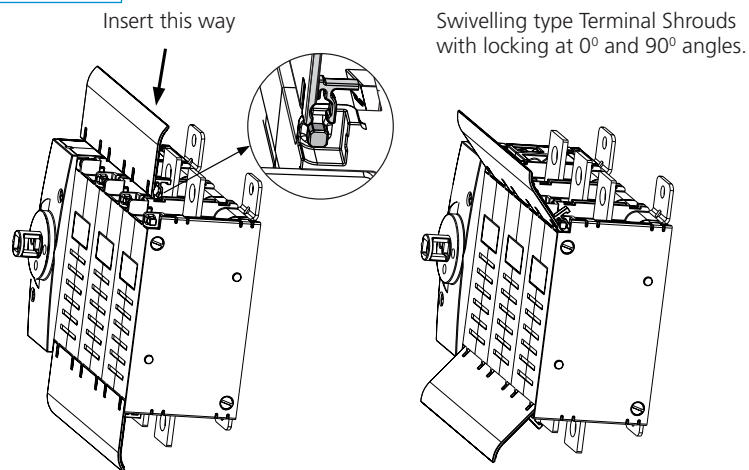

### Handle Feature - Padlock (For direct and extended handle)

Padlock without Door Interlock

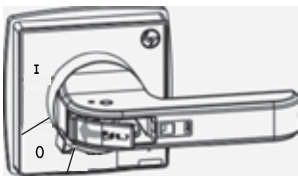

1. Flip the tag as shown.

Padlock with Door Interlock

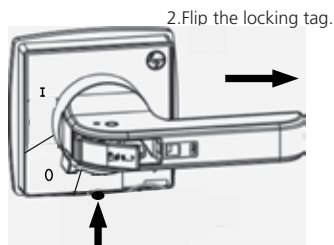

1. Push the defeat button and hold it.

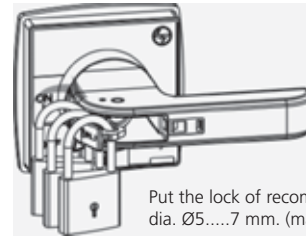

Put the lock of recommended dia. Ø5.....7 mm. (max 3 Nos.)

### Handle Feature - Interlock Defeat in on State (For extended handle only)

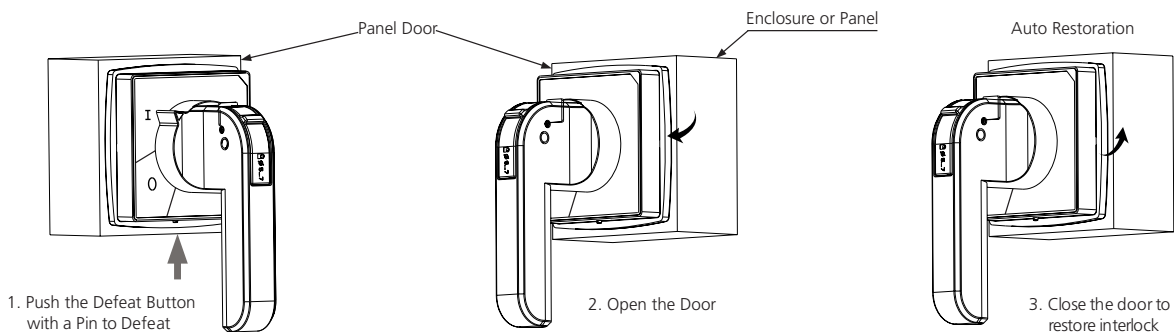

### Shaft Adjustability And Locking

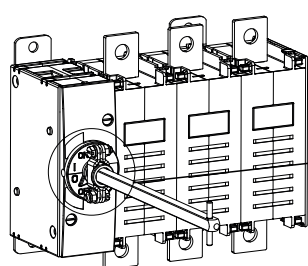

#### CAUTION

Ensure that shaft pin is vertical for any mounting orientation of the switch.

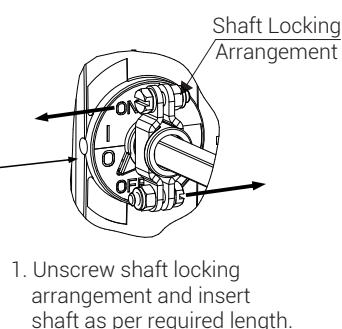

1. Unscrew shaft locking arrangement and insert shaft as per required length.

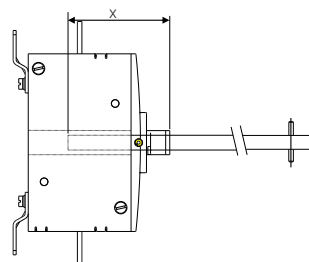

2. Adjust/Cut the shaft as per panel requirement. (Min. Engagement Length,  $X=55\text{mm}$  Inside Mechanism)

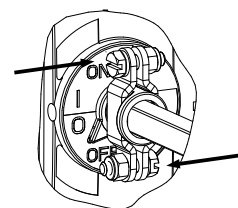

3. Tighten the Nut-Bolts. (Tighten Torque : 1.6 N-m)

### Recommended Termination Arrangements

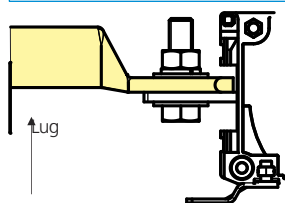

With Single Lug

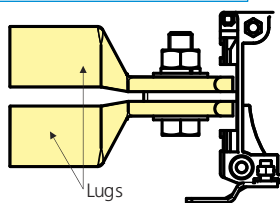

With Double Lugs

Insulation plate is recommended on bottom side for double lug connection

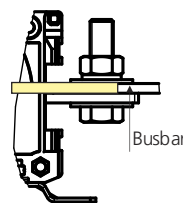

With Single Busbar

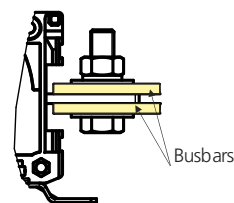

With Double Busbars

### Termination Capacity

			125/160/200/250A	315A
	TERMINATION CAPACITY AS PER STANDARD	Cable With Lug	1 X185mm <sup>2</sup>	1X240 mm <sup>2</sup>
	MAXIMUM TERMINATION CAPACITY	Cable With Lug	2 X185mm <sup>2</sup>	2 X 240mm <sup>2</sup>
		Busbar*	2 X 35mm X 10mm	2 X 35mm X 10mm
	TIGHTENING TORQUE		MAX 20 N-m AT TERMINATION	MAX 20 N-m AT TERMINATION

**Note:** For Aluminum cable, Tin plated lugs are recommended.

Termination bolt head should be on bottom side as shown in figures

\*: Higher length (M10 X 40 for 250A; M12 X 40 for 315A) of termination bolt required to connect 2 busbar of 10mm.

## Overall Dimensions

## CZ2 AC SD 315/400/630A

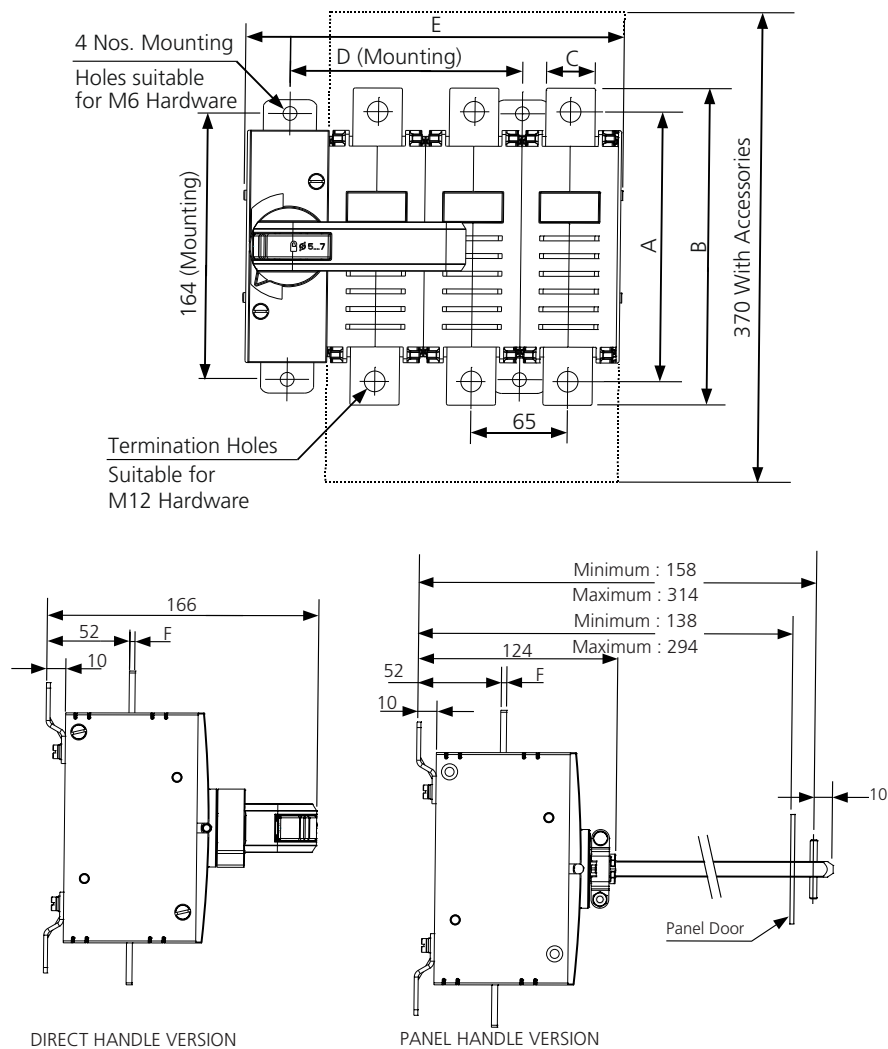

Rating (A)	No. of Poles	A	B	C	D	E	F
315/400	2P	181	206	32	90	186	4
	3P	181	206	32	155	251	4
	4P(SIDE)	181	206	32	220	316	4
	4P(CENTRE)	181	206	32	180	316	4
630	2P	184	222	45	90	186	5
	3P	184	222	45	155	251	5
	4P(SIDE)	184	222	45	220	316	5
	4P(CENTRE)	184	222	45	180	316	5

## Panel Cutout

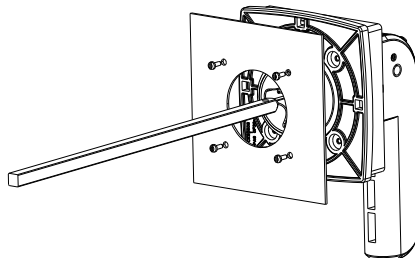
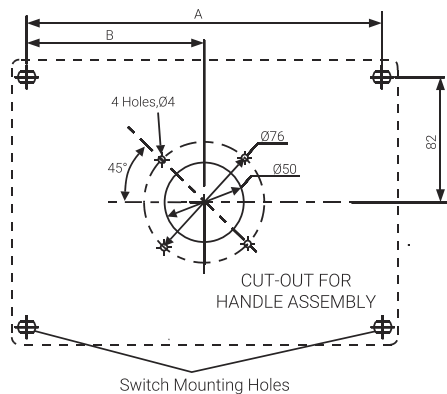

No. of Poles	A	B
2P	90	0
3P	155	0
4P - SIDE	220	0
4P - CENTER	180	90

## Mounting Orientation

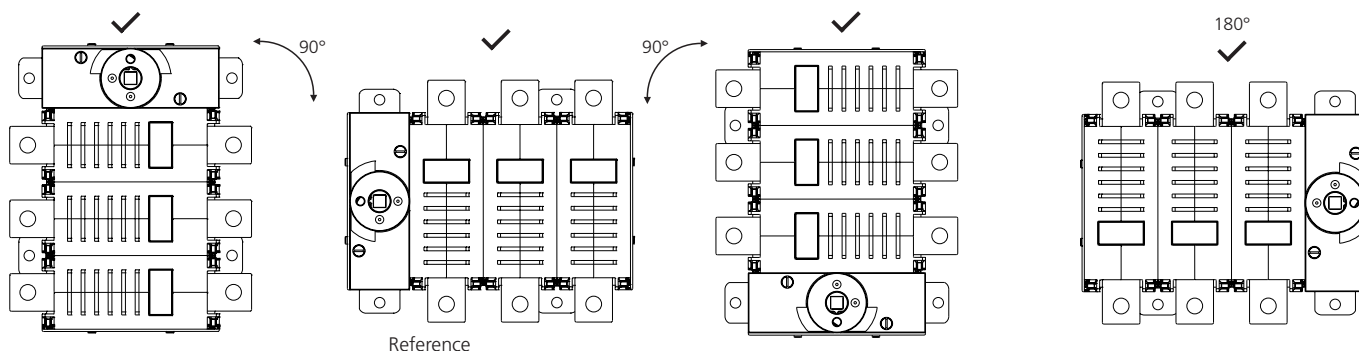

## Enclosure size and enclosure mounting

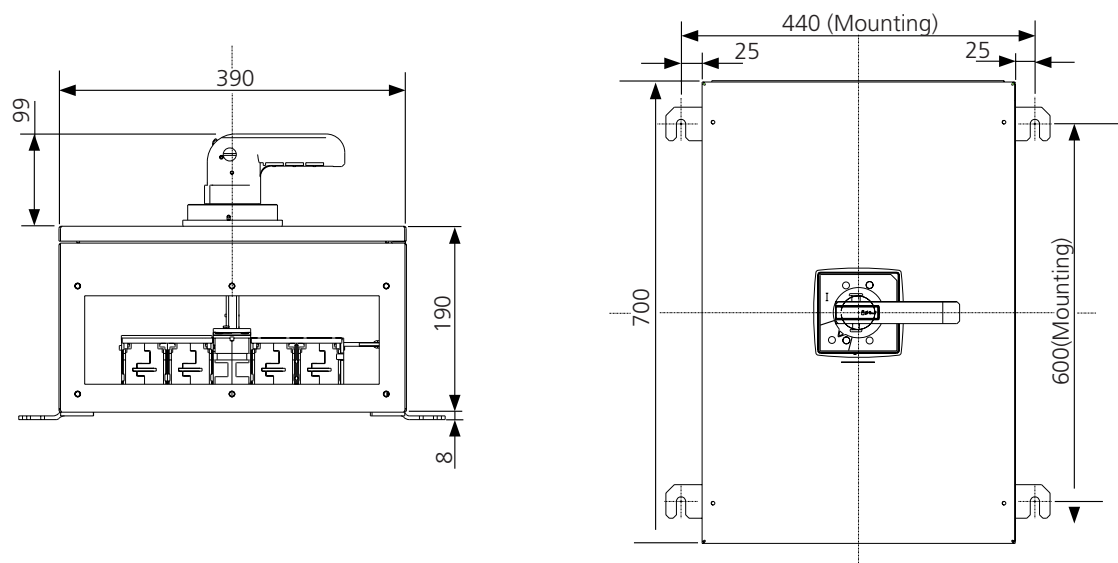



## Phase Barrier Fitment

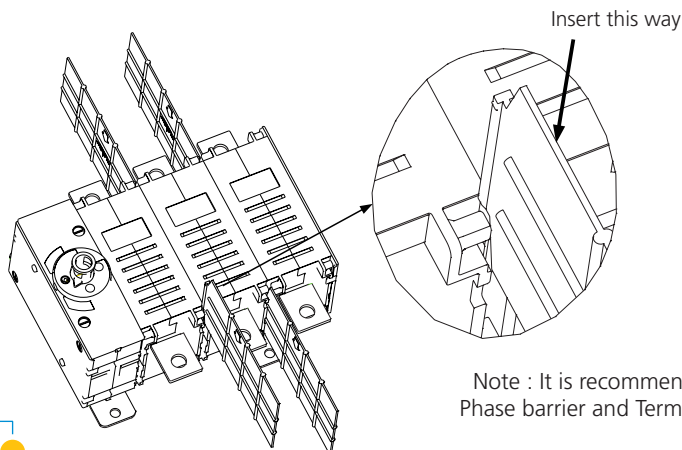

Note : It is recommended to use Phase barrier and Terminal shrouds

## Terminal Shroud Fitment

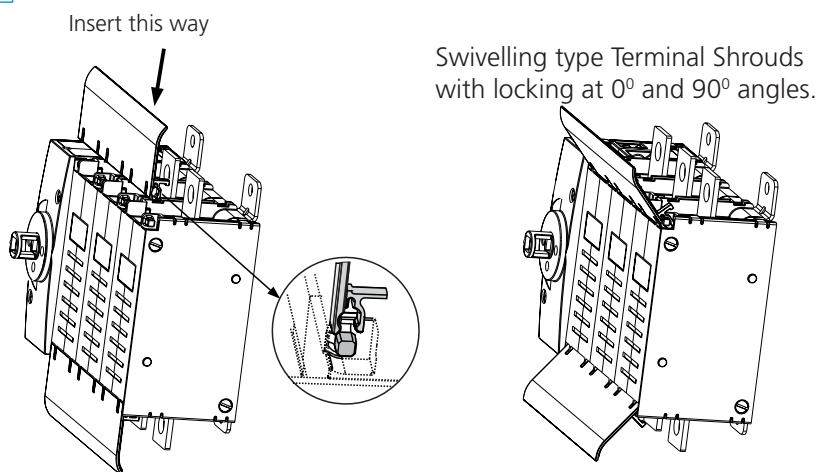

## Handle Features - Padlock

(For direct and extended handle)

Padlock without Door Interlock

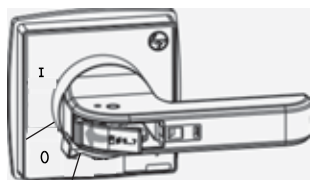

1. Flip the locking tag as shown.

Padlock with Door Interlock

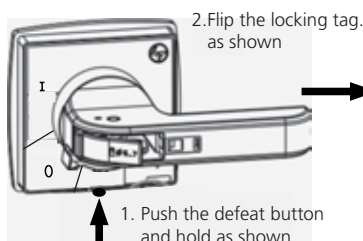

1. Push the defeat button and hold as shown

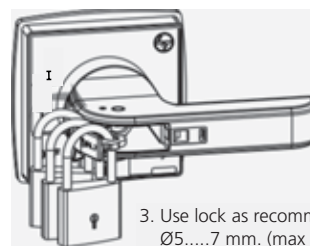

3. Use lock as recommended Ø5.....7 mm. (max 3 Nos.)

## Handle Feature - Interlock Defeat in on State

(For extended handle only)

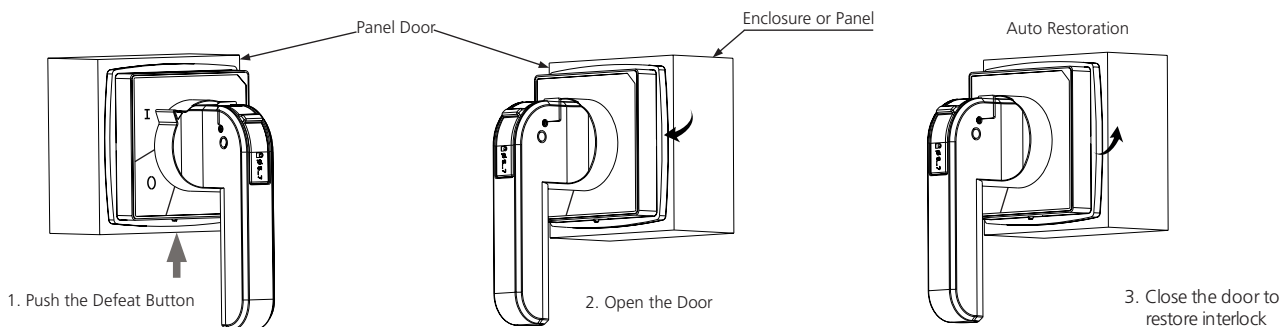

### Shaft Locking and Shaft Adjustability

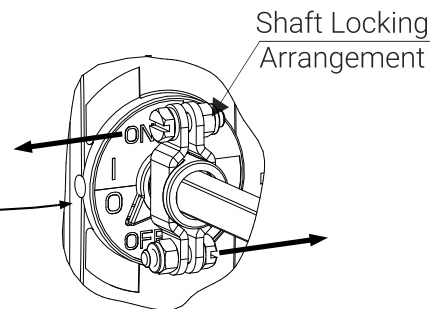
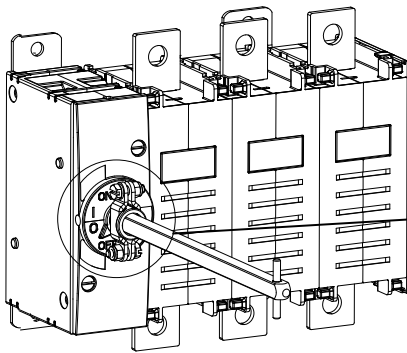

#### CAUTION

Ensure that shaft pin is vertical for any mounting orientation of the switch

1. Unscrew shaft locking arrangement and insert shaft as per required length.

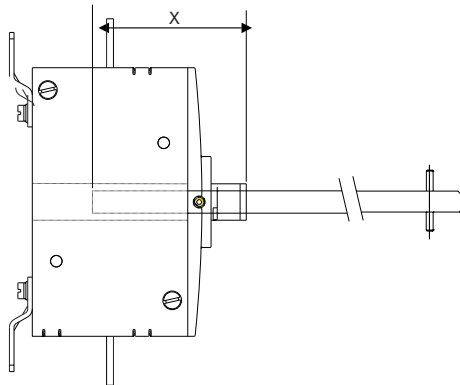

2. Adjust/Cut the shaft as per panel requirement. (Min. Engagement Length,  $X=60\text{mm}$  Inside Mechanism)

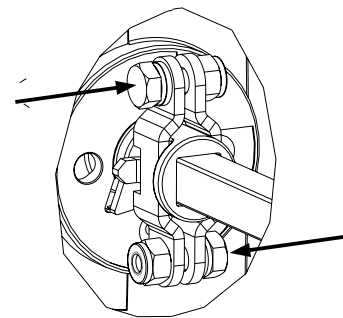

3. Tighten the Nut-Bolts (Torque : 1.6 N-m Tighten)

### Recommended Termination Arrangements

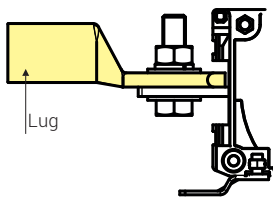

With Single Lug

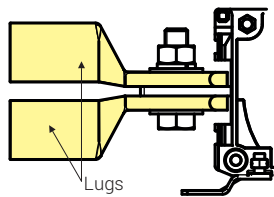

With Double Lugs  
Insulation plate is recommended on bottom side for double lug connection

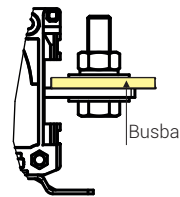

With Single Busbar

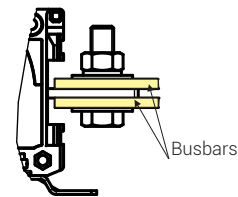

With Double Busbars

### Termination Capacity

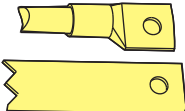
			315/400A	630A
	TERMINATION CAPACITY AS PER STANDARD	Cable With Lug	2 X150mm <sup>2</sup>	2 X 300mm <sup>2</sup>
		Busbar*	2 X 25mm X 10mm	2 X 30mm X 12mm
	MAXIMUM TERMINATION CAPACITY	Cable With Lug	2 X 300mm <sup>2</sup>	2 X 300mm <sup>2</sup>
		Busbar*	2 X 50mm X 12mm	2 X 50mm X 12mm
	TIGHTENING TORQUE		MAX 27 N-m AT TERMINATION	MAX 27 N-m AT TERMINATION

Note: For Aluminum cable, Tin plated lugs are recommended. Termination bolt head should be on bottom side as shown in figures

### 1. Auxiliary Contact Installation for Direct Handle Version

1.1. Open Locking Tag

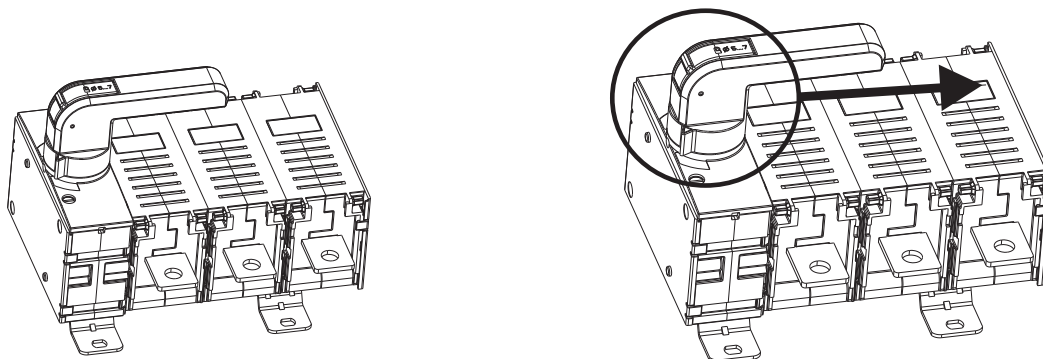

1.2. Unscrew the Handle from Switch

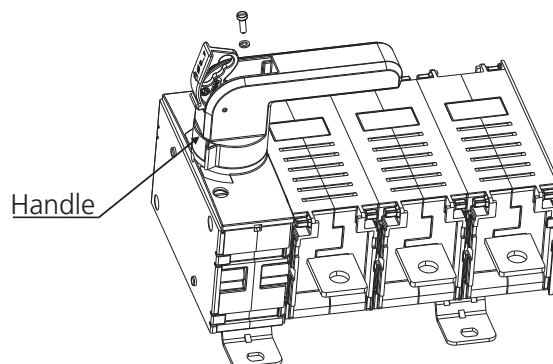
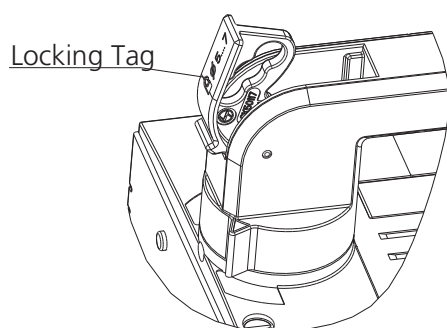

1.3. Remove Handle from Switch

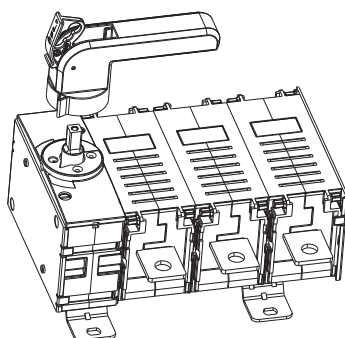

1.4. Unscrew and Remove Aux cover

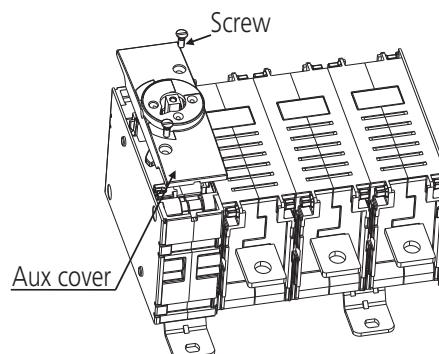

## 1. Auxiliary Contact Installation for Direct Handle Version

1.5. Insert Auxiliary contact assembly in slot provided in switch

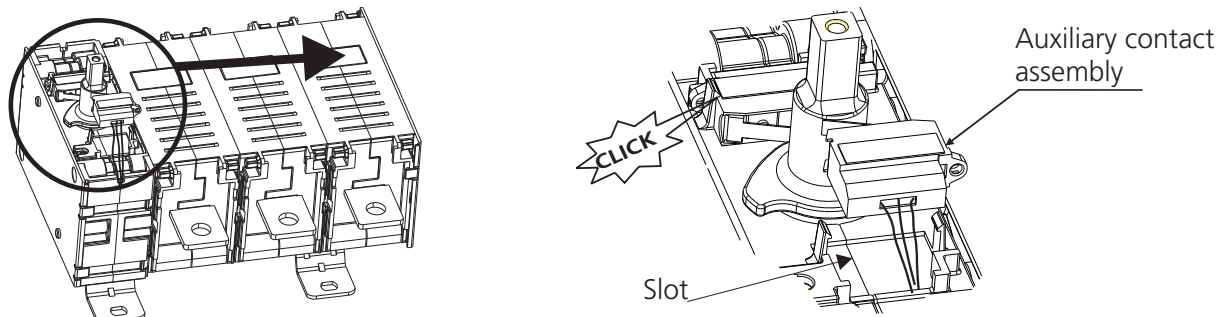

1.6. Assemble Aux cover and Handle with Screws

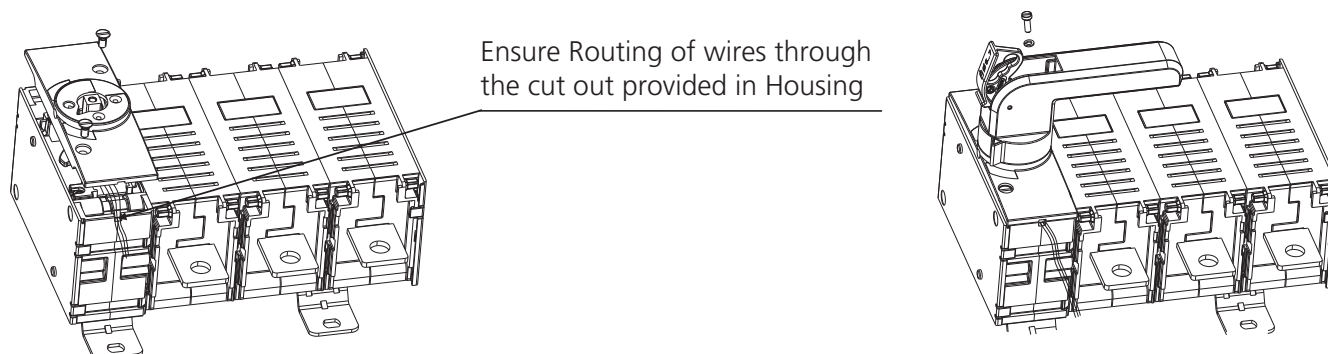

## 2. Auxiliary Contact Installation Instructions

For Panel Handle Version and Bypass Switch

2.1. Remove Shaft clamp assembly and Shaft from switch

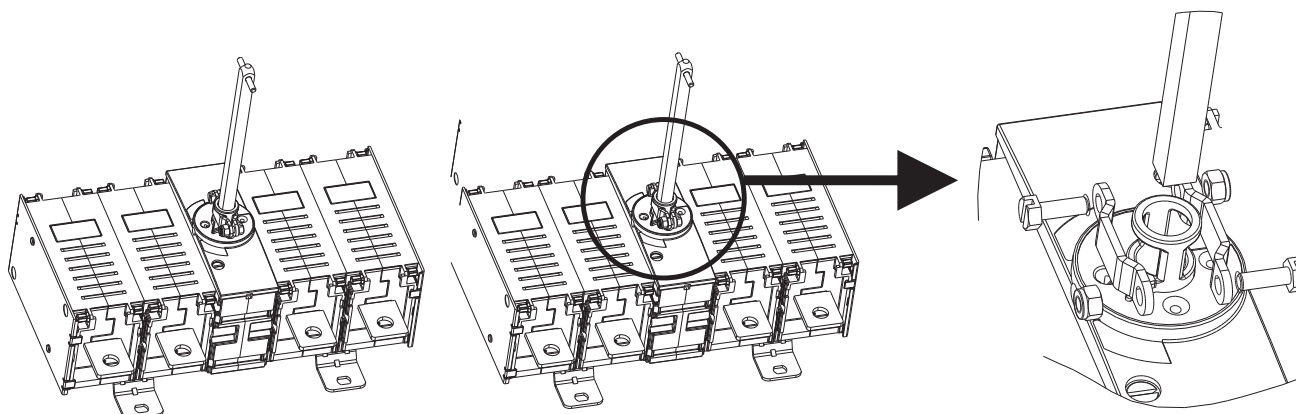

### 2. Auxiliary Contact Installation Instructions

For Panel Handle Version and Bypass Switch

#### 2.2. Unscrew and Remove Aux cover from switch

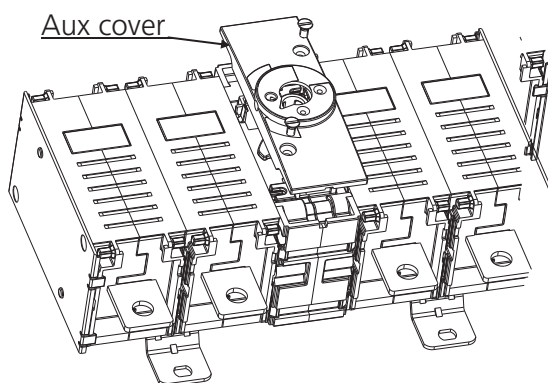

#### 2.3. Insert Auxiliary contact assembly in slot provided in switch

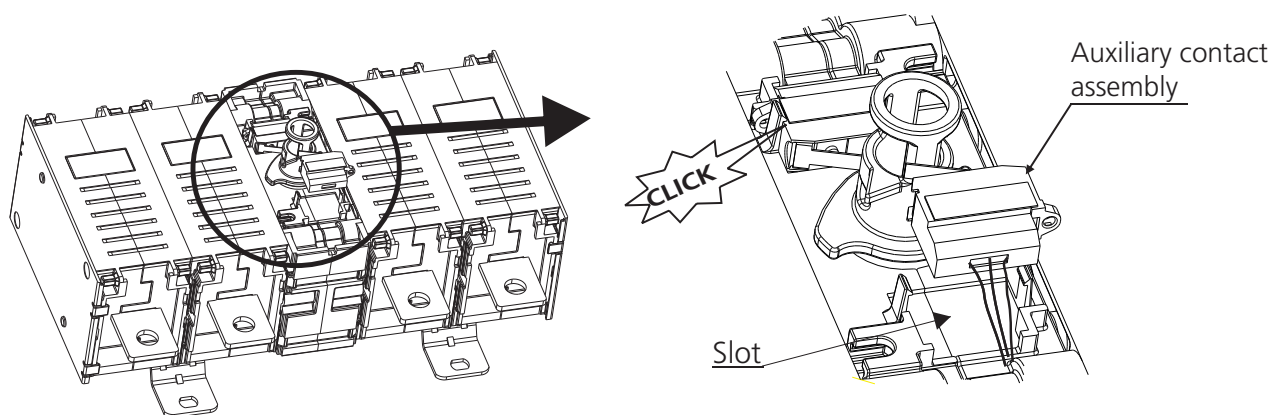

#### 2.4. Assemble Aux cover with screws

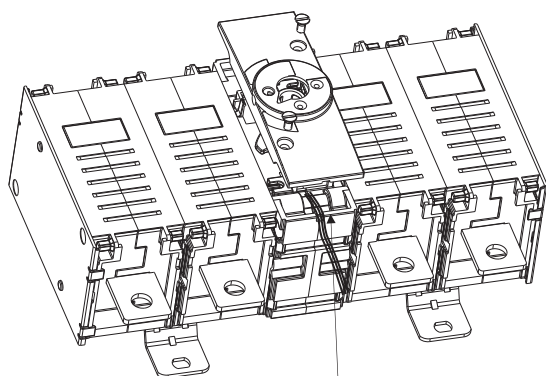

#### 2.5. Assemble Shaft and Shaft clamp with screws

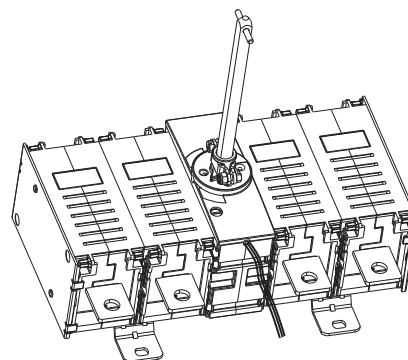

Ensure Routing of wires through the cut out provided in Housing



## Electrical Standard Products (ESP) Offices:

### HEAD OFFICE

L&T Electrical & Automation  
TC-II, Tower B, Prima Bay,  
Gate No. 5, Saki Vihar Road, Powai,  
**MUMBAI - 400072.**  
Tel: 022-67052874 / 2737 / 1156  
e-mail: cic@Lntebg.com

### BRANCH OFFICES

L&T Electrical & Automation  
C-201, The First Commercial Complex,  
B/S Keshaybaug Party Plot, Vastrapur,  
**Ahmedabad - 380015**  
Toll Free: 1800 233 5858 / 1800 200 5858  
e-mail: CIC@Lntebg.com

L&T Electrical & Automation  
Wework Central, #36 Infantry Road,  
**Bengaluru - 560 001**  
Toll Free: 1800 233 5858 / 1800 200 5858  
e-mail: CIC@Lntebg.com

L&T Electrical & Automation  
Under O Launchpad, 4th floor,  
Esplanade 1, Rasulgarh  
**Bhubaneswar - 751010**  
Toll Free: 1800 233 5858 / 1800 200 5858  
e-mail: CIC@Lntebg.com

L&T Electrical & Automation  
4th floor, SCO-54,55,56,  
Sector -17A  
**Chandigarh - 160017**  
Toll Free: 1800 233 5858 / 1800 200 5858  
e-mail: CIC@Lntebg.com

L&T Electrical & Automation  
Olympia Technology Park,  
10th Floor, CITIUS A Block,  
Plot No. 1, Phase 1, Guindy,  
**Chennai - 600032**  
Toll Free: 1800 233 5858 / 1800 200 5858  
e-mail: CIC@Lntebg.com

L&T Electrical & Automation  
Playworkz Coworking Space  
43 & 44, 3rd Cross,  
Bharathy Colony, Peelamedu,  
**Coimbatore - 641004**  
Toll Free: 1800 233 5858 / 1800 200 5858  
e-mail: CIC@Lntebg.com

L&T Electrical & Automation  
3rd Floor, 1&2 Vijay Park,  
Main Chakrata Road, Opp. Anandam  
Near Ballupur chowk,  
**Dehradun - 248001**  
Toll Free: 1800 233 5858 / 1800 200 5858  
e-mail: CIC@Lntebg.com

L&T Electrical & Automation  
Ground Floor, B-27, Biplot Rashbihari Sarani,  
Sector 2A, Bidhan Nagar,  
**Durgapur - 713212**  
Toll Free: 1800 233 5858 / 1800 200 5858  
e-mail: CIC@Lntebg.com

L&T Electrical & Automation  
6th floor, Exotica Greens, A Block, 191,  
R G Baruah Road, Guwahati Central,  
**Guwahati - 781005**  
Toll Free: 1800 233 5858 / 1800 200 5858  
e-mail: CIC@Lntebg.com

L&T Electrical & Automation  
Shri Daneshwari, 1st Floor,  
Plot No. 17, 2nd Cross,  
Near Old Income Tax Office Road,  
Vidyanagar,  
**Hubballi - 580021**  
Toll Free: 1800 233 5858 / 1800 200 5858  
e-mail: CIC@Lntebg.com

L&T Electrical & Automation  
AWFIS space solutions, Prestige Phoenix,  
4th floor, 1405, Umanagar, Begumpet,  
**Hyderabad - 500016**  
Toll Free: 1800 233 5858 / 1800 200 5858  
e-mail: CIC@Lntebg.com

L&T Electrical & Automation  
Workie, 214 - 2nd Floor,  
Apollo Premier, PU-4,  
Scheme No. 54,  
Vijay Nagar Square,  
**Indore - 452010**  
Toll Free: 1800 233 5858 / 1800 200 5858  
e-mail: CIC@Lntebg.com

L&T Electrical & Automation  
Office No 430, 4th floor,  
Jaipur Electronic Market  
Riddhi Siddhi,  
Gopalpura Bypass,  
**Jaipur - 302018**  
Toll Free: 1800 233 5858 / 1800 200 5858  
e-mail: CIC@Lntebg.com

L&T Electrical & Automation  
GDR Siddha, Ground Floor, N Road  
Bistupur, Opposite St. Mary's Church,  
**Jamshedpur - 831001**  
Toll Free: 1800 233 5858 / 1800 200 5858  
e-mail: CIC@Lntebg.com

L&T Electrical & Automation  
Business Communication Centre  
2nd Floor, Chiramel Chambers,  
Kurisupally Road,  
Ravipuram,  
**Kochi - 682 015**  
Toll Free: 1800 233 5858 / 1800 200 5858  
e-mail: CIC@Lntebg.com

L&T Electrical & Automation  
2nd Floor, BN3, Salt Lake, Sector-V,  
**Kolkata - 700091**  
Toll Free: 1800 233 5858 / 1800 200 5858  
e-mail: CIC@Lntebg.com

L&T Electrical & Automation  
No. 10, Fortuna Towers, 2nd floor,  
Rana Pratap Marg, Near NBRI  
**Lucknow - 226001**  
Toll Free: 1800 233 5858 / 1800 200 5858  
e-mail: CIC@Lntebg.com

L&T Electrical & Automation  
El Dorado Building 3rd Floor,  
6, Venkatraman Street,  
Chinna Chokkikulam  
**Madurai - 625 002**  
Toll Free: 1800 233 5858 / 1800 200 5858  
e-mail: CIC@Lntebg.com

L&T Electrical & Automation  
TC II, Tower B, PRIMA BAY  
Gate no. 5, Saki Vihar Road Powai,  
**Mumbai - 400072**  
Toll Free: 1800 233 5858 / 1800 200 5858  
e-mail: CIC@Lntebg.com

L&T Electrical & Automation  
Unnati Building, 2nd floor,  
Automation Campus, A-600, TTC Industrial area  
Shil-Mahape road, Mahape  
**Navi Mumbai - 400710**  
Toll Free: 1800 233 5858 / 1800 200 5858  
e-mail: CIC@Lntebg.com

L&T Electrical & Automation  
M1 & M2, Mezzanine Floor,  
Himalaya Excellency, Plot No- C - 47,  
Pratap Nagar Square,  
**Nagpur - 440022**  
Toll Free: 1800 233 5858 / 1800 200 5858  
e-mail: CIC@Lntebg.com

L&T Electrical & Automation  
A-25, 1st Floor, Imperia Complex,  
Mohan Corporate Industrial Estate,  
Near Sarita Vihar Metro Station,  
Mathura Road,  
**New Delhi - 110044**  
Toll Free: 1800 233 5858 / 1800 200 5858  
e-mail: CIC@Lntebg.com

L&T Electrical & Automation  
A06/A07, Second Floor,  
Grand Chandra complex, Frazer road  
**Patna - 800001**  
Toll Free: 1800 233 5858 / 1800 200 5858  
e-mail: CIC@Lntebg.com

L&T Electrical & Automation  
UrbanWrk, 5th Floor, Sai Radhe,  
Raja Bahadur Mill road, Behind Hotel  
Grand Sheraton, Sangamwadi  
**Pune - 411001**  
Toll Free: 1800 233 5858 / 1800 200 5858  
e-mail: CIC@Lntebg.com

L&T Electrical & Automation  
Unit No. 207, 2nd Floor, Wallfort Ozone,  
Raipur Road, Near Fafadih Chowk,  
**Raipur - 492001**  
Toll Free: 1800 233 5858 / 1800 200 5858  
e-mail: CIC@Lntebg.com

L&T Electrical & Automation  
10th Floor, Titaanium Business,  
Bhimrad Road, Althan  
**Surat - 395017**  
Toll Free: 1800 233 5858 / 1800 200 5858  
e-mail: CIC@Lntebg.com

L&T Electrical & Automation  
11th Floor, Block-D, Notus IT Park,  
Sarabhai Campus, Bhailal Amin Marg,  
**Vadodara - 390023**  
Toll Free: 1800 233 5858 / 1800 200 5858  
e-mail: CIC@Lntebg.com

L&T Electrical & Automation  
414, 4th Floor, Naga Chambers,  
Opposite HDFC Bank  
Ram Nagar, Waltair Main Road  
**Visakhapatnam - 530002**  
Toll Free: 1800 233 5858 / 1800 200 5858  
e-mail: CIC@Lntebg.com

Product improvement is a continuous process, For the latest information and special application, please contact any of our offices listed here.  
Product photographs shown for representative purpose only.



L&T Electrical & Automation, Electrical Standard Products  
TC-II, Tower B, Prima Bay, 3rd Floor, Gate No. 5, Saki Vihar Road, Powai,  
Mumbai - 400 072, INDIA. Web: www.Lntebg.com

Customer Interaction Centre (CIC)  
BSNL/MTNL (toll-free): 1800 233 5858 Reliance (toll-free): 1800 200 5858  
Tel: 022 6774 5858 Email:cic@Lntebg.com Web: www.Lntebg.com